



FÖS

l i g h t i n g

Wellness & Hospitality

foslighting.com.au

FOS Lighting

THE FOS EXPERIENCE

FOS Lighting has an experienced engineering and design team who understand the architectural landscape of the lighting sector and its clients, while a dedicated manufacturing team brings cutting edge solutions to market. With quality and experience, FOS Lighting manufactures and distributes a complete selection of quality luminaires and lighting control systems to the following sectors:

- Office & Communication
- Science & Education
- Art & Culture
- Industry & Engineering
- Transport & Environment
- Adverse & Custodial
- Living & Lifestyle
- Retail & Presentation
- Care & Health
- Leisure & Entertainment
- Sports & Recreation
- Experience & Advertising
- Urban & Architecture
- Wellness & Hospitality



FOS QUALITY

FOS Lighting is a proud manufacturer and exclusive distributor of cutting-edge luminaires within Australia and New Zealand. With our integrated distribution and manufacturing facilities in Melbourne and Brisbane, we can provide a lighting solution from concept to delivery. FOS Lighting is known for its outstanding workmanship, quality, and getting the job done - its International ISO 9001:2015 accreditation is testament to this.



THE FOS WAY

FOS Lighting is a solutions driven, innovative lighting and controls business using in-house experience and engineering coupled with manufacturing facilities in Australia. Working closely with key account customers, its project lighting solutions business is based on innovative lighting concepts using leading edge technology to generate new levels of impact in both design and function.

FOS Lighting is highly regarded in the market for its knowledge of the lighting industry, this is made possible with its committed, highly talented and motivated team members, that continuously strive to provide the highest quality of product and service in the Australian and New Zealand market.

FOS - WE DELIVER

FOS Lighting is dedicated to achieving the desired lighting solution for all lighting requirements. The combination of our experienced research and development teams leveraging the power of the latest technology in 3D modelling programs, and reliable delivery of materials from our trusted and dependable suppliers allow us to meet client expectations and deliver on time.

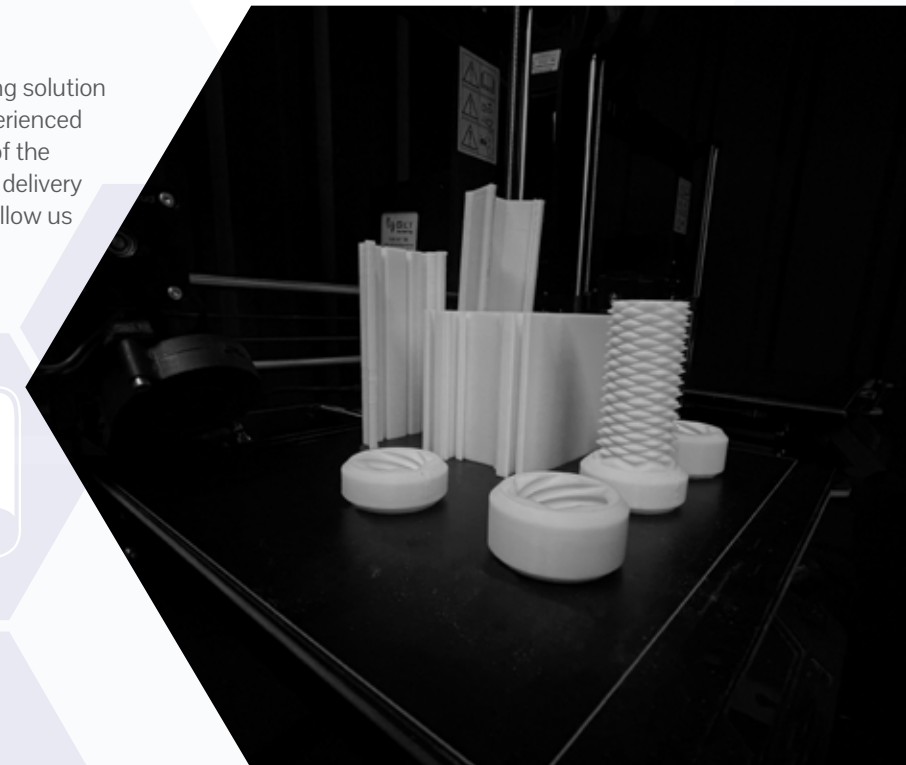



Contents

FOS Lighting	2
Solution Centre	6
The Right Light	8
Acoustic Management	11
Lobby & Foyer	12
Rooms & Suits	14
Corridors	16
Restaurant	18
Recreational Areas	20
Multi Use Areas	22
Technical Equipment Room	24
Ammenities	26
Stairs & Lifts	28
Courtyards & Gardens	30
Paths & Walkways	32
Facade Lighting	34
Parking	36
FOS Projects	38

Solution Centre

Wellness and Hospitality covers a broad range of topics and areas within a variety of organisations. Providing a “home away from home” requires a variety of spaces for numerous activities by guests as well as the provision of services to support the guests. An integral component of the space is the associated illumination, whether it is the provision of task lighting over a desk or the provision of soft indirect illumination in a Day Spa, FOS Lighting and the brands we represent have the solutions you require. We do not only supply luminaires but also the dedicated control systems required to match their performance to the needs of the situation, be it lighting a single guest room or a banquet hall.

Parking

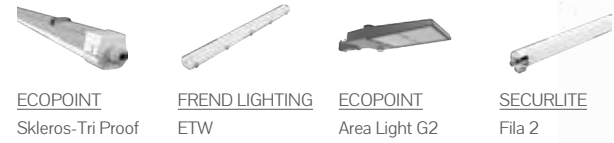

Facade Lighting



Paths & Walkways

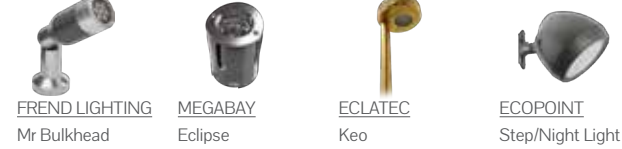

Lobby & Foyer

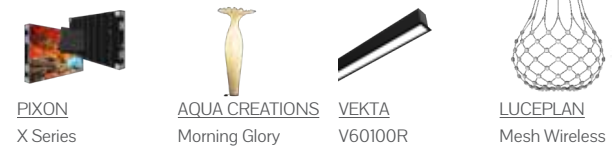

Amenities



Courtyards & Gardens

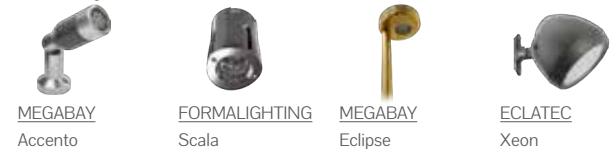

Technical Equipment Rooms



Rooms & Suites



Stairs and Lifts



Corridors



Multi Use Areas



Recreational Areas



Restaurant



The Right Light

Lighting in general can impact the overall experience of a guest, and this is why the right light is so important. Lighting can directly effect the mood of guest, luminaires that imitate natural light can increase the productivity of staff as well as energise them, whereas dim lighting can help guests fall asleep or relax. For example, when looking at a lobby of a hotel there are multiple spaces that need to be illuminated differently. Lighting above the reception desk should help staff complete their daily tasks without them feeling fatigued, whereas lighting above a sofa needs to allow guest to wind down while they wait for other guests or transport to their next destination. Lighting can heavily impact the guests of a hotel and this is why the right light for the area is so crucial.

Task lighting varies with the nature of the task under consideration. Not only the level of illumination but also the frequency of the light provided should be matched to the needs of the task under consideration. When considering providing a workspace for guests it is essential that the illumination at the height of the desk/table surface meets the needs of AS/NZS 1680 and avoids casting glare on the screens of digital devices such as laptops and iPad type devices. As there is variation between individuals regarding the amount of illumination they find comfortable, it is recommended that the task lighting be capable of adjustment. If the guest requires additional illumination to perform a precise or technical task the provision of portable lamps would provide an effective solution. FOS Lighting provides a number of task lighting options, from linear surface mounted to recessed solutions which can be custom manufactured for you in our ISO9001 certified factory in Brisbane. We can also supply a number of downlight, table and wall mounted options capable of meeting the most exacting design standards.

In addition to delivering sufficient illumination to perform various tasks required of guests involved in business and leisure travel, the lighting in hotel rooms also should be adaptable to different applications. Rest and relaxation are as essential as efficient work performance to a well-rounded travel experience. This is where being able to adjust the illumination within a space becomes important. Circadian rhythms require light of different frequencies at different times of the day for optimum performance. A number of LED manufacturers have provided a range of luminaires that are compatible with these requirements. The so-called “dim to warm” as well as variable white luminaires are all options that are ways of addressing the Circadian Rhythm needs of guests via control systems that are designed to maximise the Human-Centric nature of illumination.

FOS Lighting has the expertise to guide your selection of luminaires and associated controls to ensure that your guests enjoy the best of all worlds during their stay in your facility and gain the maximum enjoyment from the facilities that you provide for their work and leisure activities.



Project: Cornwalls Law
Builder: McCORMACK
Photo credit: Shannon McGrath
Courtesy: McCORMACK

Acoustic Management

In shared spaces – for work, study, dining, leisure – noise pollution caused by unwelcome or irritating sounds can have a negative impact on human psychological wellbeing. Lighting conditions also influence our mood and health, playing a fundamental role in the creation of a space suited to variety of needs. Supplying proper lighting and greater acoustic control at the same time, for better comprehension of speech and reduction of noise propagation, makes it possible to generate a comfortable environment, contributing to boosting wellbeing and consequently productivity. This is especially relevant in shared spaces where teleconferencing and face to face meetings are conducted.

Background noise, particularly in modern buildings, can often become uncomfortably loud, due to the predominance of sound-reflecting materials. The design of the room (shape, furnishings, surface finishes, etc.) influences the extent to which the sound level decreases in relation to distance. An unfurnished room with sound reflective surfaces, such as a church, or open plan offices surrounded by glass, are perceived as being more reverberant than a well-furnished living room. The materials used in the acoustic luminaire ranges provide sound absorption and prevent acoustic overlap, particularly in the case of human voice, which lies in the frequency range between 200 and over 3000 hertz (Hz).

Luceplan, a specialist brand represented by FOS Lighting, has extensive experience in the creation of “all-in-one” solutions that combine innovative technical lighting and sound-absorbing performance. A series of products that are true architectural statements capable of defining and personalizing any context. Luceplan Lighting systems combine solutions to decor and acoustic comfort for public and private settings. FOS Lighting can provide a range of fixtures suited to your specific acoustic and lighting needs.



Project: Sonium Headquarters, Alicante, Spain
Architect: Monica Armani
Photo credit: CUL DE SAC
Courtesy: Luceplan



Courtesy of: Formalighting
Project: Hyatt Regency

Lobby & Foyer

The Grand Entrance

The Lobby/foyer of a hotel is a make-or-break environment for a guest, it is the first impression of the hotel and what it has to offer. Get this wrong and the guest's overall perception of everything within the hotel may be lowered. So, what makes this area? The lighting. A well-lit lobby/foyer creates an inviting and safe environment, architectural or art formed lighting can enhance the overall experience for the guest, while embedding the overall brand aesthetic of the hotel. "Recommended maintained illuminance should be 160 lux. The luminaires used should be of such a type or so located that persons entering or leaving the area will not suffer a significant loss of visibility resulting from glare from the luminaires." AS/NZS 1680.2.1

However, it is not all about the guests. Efficient and effective task lighting is required for the staff and to fulfil their requirements it is recommended luminance increase to 320 lux at enquiry desks and be designed in a way that does not produce glare and reflections on video screens.

FOS Lighting have a large variety of ideal products for creating the perfect lobby.



AQUA CREATIONS
Morning Glory



AQUA CREATIONS
Mino Family



AQUA CREATIONS
Zooid Diamond Pendant



PIXION TECHNOLOGY
X Series

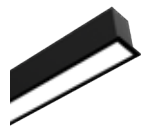

VEKTA
V60100R

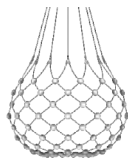

LUCEPLAN
Mesh Wireless



FORMALIGHTING
Colosseo Round

PIXION TECHNOLOGY - X Series

LED Displays are a great addition to a lobby or foyer, as they allow any environment to be customised and personalised to the company.

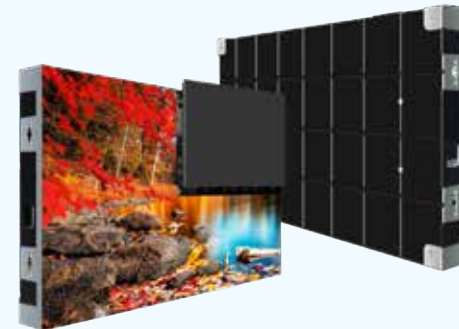

Features

- Application are endless.
- Create experience and immersive environments.
- Moving or static walls.

AQUA CREATIONS - Morning Glory

The Morning Glory is a hand crafted organic architectural floor lamp made with silk and metal. The lamp casts a soft glow, enhancing the style of any space.

Features

- Hand Crafted.
- Dimmable.
- Custom sizes & colours available.



VEKTA - V60100R

Endless possibilities with a linear recessed profile, with customisation & adaptability embedded within its design.

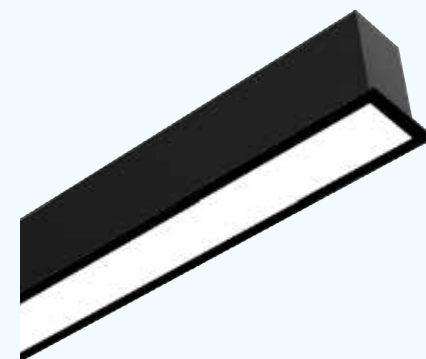

Features

- Emergency options available on request.
- Welded joints on request.
- Available optics include Opal Diffuser, Linear Lenses, Track, Louvered & Mini Spots.



LUCEPLAN - Mesh Wireless

The wireless capability of Mesh Wireless offers users total freedom and control over the suspended fitting.

Features

- Available in 100 & 80cm diameter fittings.
- Custom moods and experiences.
- Steel structure and polycarbonate lenses.

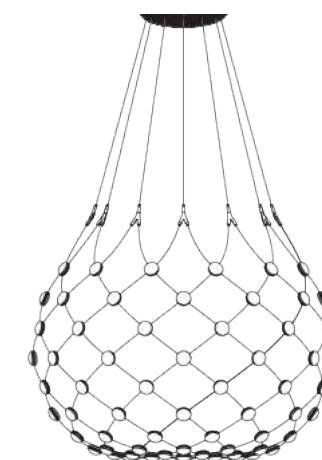



Courtesy of: FOS Lighting

Rooms & Suits

Home Away From Home

Hotel rooms are a very important part of the accommodation experience for guests. In effect it is peripheral factors that make up the difference between 1 and 5 star accommodation. Included in this is the lighting that guests have at their disposal and the control systems associated with it. Luxury accommodation requires flexibility in use - a significant part of the guests that utilise luxury hotels do so for business. This implies that rooms must be able to provide an environment for work as well as relaxation. This requires that the illumination in various parts of the suite is adapted to its use. Lighting over desks needs to deliver the required levels of illuminance while at the same time avoiding reflections for screen-based tasks. The lighting around the bed needs to be compatible with circadian rhythms and be capable of dimming control while utilitarian sections of the accommodation need to have suitable levels of illumination for the exacting tasks to be conducted such as shaving, makeup etc.

FOS Lighting has several ranges of suitable luminaires and associated control systems suitable for any budget.



VEKTA - VEKTA MICRO

The VEKTA MICRO Series is a family of luminaires for under-counter illumination.

Features

- Even Illumination.
- Supplied with all mounting accessories.
- Custom finishes to integrate seamlessly into any environment.



FREND LIGHTING - KATO E

KATO E is a family of architectural lights which come in a range of mounting options, finishes, and outputs.

Features

- Mounting options include Recessed Downlight, Surface Mounted, Pendant, Wall mounted Up and/or down.
- 250, 400 & 600mm tube options for surface mounted, pendant and wall mounted options.
- Black and white as standard colours (custom colours available on request).



SECURLITE - Senspot

Extra-compact LED downlight with detection

Features

- IK10 or IK11.
- Clear/white polycarbonate diffuser.
- IP44 or IP65 options available.



LUCEPLAN - Constanzina Wall

Constanzina wall is a perfect option for next to bed lighting. With its discrete but solid presence, Constanzina can be easily positioned, while the two point mounting system allows for the shade to swing without falling off.

Features

- Polycarbonate silk screened shade.
- 10 different shade colours
- 42W or 12W power options.





Courtesy of: Brand
Project: Name

Corridors

The Path Everywhere

Corridors and passageways and their illumination is central to the “look and feel” of a hotel. They also serve an important secondary function in that they represent emergency egress route marking in the event of a natural or man-made disaster. The level of maintained illuminance at the floor level should be 40 lux, but may be lower in the evenings when ambient light is lowered. The level has to increase to 80 lux in the event of stairs and similar trip hazards being part of the design. The emergency lighting needs to conform to the AS/NZS 2293 standard, in terms of visibility as well as battery life, lighting designers apply the standards as they apply to the use of a structure. FOS Lighting has a range of emergency fittings that will suit your project and application.



VEKTA - V60100

VEKTA V60100 provides a breath of opportunity for lighting creativity with its wide variety of options and customisation features.



Features

- Emergency options available on request.
- Welded joints on request.
- Available optics include Opal Diffuser, Linear Lenses, Track, Louvered & Mini Spots.
- Available mounting options include Surface, Suspended, Recessed & Wall mounted.

LUCEPLAN - Garbi

With its soft curves and clean edges, as well as its indirect light source, the Garbi is an eye pleasing and effective luminaire for corridor illuminations.

Features

- Textured White
- 2700K or 3000K options
- CRI > 90



FRENDA LIGHTING - FWL-M

The FWL-M series is a variety of recessed & surface mounted downlights, perfect for a variety of applications.



Features

- Optional IP65 lens (dependent on downlight)
- High Colour rendering downlight options
- Optional adaption plates for retrofitting (dependent on downlight)
- Optional IK10 accessories (dependent on downlight)

SECURLITE - Senspot

Extra-compact LED downlight with detection

Features

- IK10 or IK11.
- Clear/white polycarbonate diffuser.
- IP44 or IP65 options available





Project: Sokyo

Restaurant

Dining Out

Part of the branding of a restaurant is the ambiance that it wishes to convey to clientele. This is achieved via a combination of interior design, objets 'd art and targeted illumination. Lighting in a restaurant has to be able to provide the focal points that the architecture and table layout requires as well as be able to resist frequent cleaning with chemical agents. The kitchen itself has even more stringent requirements regarding IP ratings.

Clientelle and staff require ambient light to assist with wayfinding (especially if there are steps or similar hazards that need to be highlighted) while the settings need sufficient illumination to allow people to admire the presentation of food and beverages and to identify the expressions of the people they are conversing with.

From a housekeeping and management perspective it is essential that the light levels can be adjusted to assist with the cleaning cycle and permit staff to identify and clean any spills and marks on crockery and cutlery while setting tables for the next service. Motorised luminaires with built-in memories permit the adaptation of illumination to different layouts on the fly without disrupting service, ensuring that the overall look and feel of the establishment is maintained.



ECOPOINT
Compact Downlight

VEKTA
V60100

VEKTA
V1718

FORMALIGHTING
Gimbal

FORMALIGHTING
Mini Cobra Flex

FORMALIGHTING
Moto Zero Compasso
40

FRENDLIGHTING
Microline Spot Chain



Formalighting - Moto Zero Compasso

A tiny and versatile spotlight ideal for applications where the distance between ceiling and spot is an issue. The Moto-Zero Zoom series is the ideal solution for museum and retail application. The fixture enable users to focus on a narrow to wide spot at the touch of a button.

Features

- IP20.
- CRI>90.
- Beam angles: Super narrow, Narrow, Medium and Wide.
- Vertical rotation - 90.
- Horizontal rotation - 350.

Formalighting - Microline Spot Chain

Microline is a miniature surface mounted linear system with a disappearing appearance.

Features

- IP20.
- Beam angles: 21, 29 and 22x47.
- CCT ranging from 2100K to 4000K as standard.
- U mounted, L mounted or integrated magnets for easy installation.



Ecopoint - Compact Downlight G2

The compact downlight G2 is an efficient modern luminaire, which features a faceted specular reflector protected by a clear intermediate lens.

Features

- IP54
- Ra ≥ 80
- Available in a variety of power outputs
- Available in a variety of sizes
- <25W is it IC4 rated



VEKTA - V60100

VEKTA V60100 provides a breath of opportunity for lighting creativity with its wide variety of options and customisation features.

Features

- Emergency options available on request.
- Welded joints on request.
- Available optics include Opal Diffuser, Linear Lenses, Track, Louvered & Mini Spots.
- Available mounting options include Surface, Suspended, Recessed & Wall mounted.





Project: 31 Queen Street, Victoria

Recreational Areas

Work hard, Play hard

Many hotels offer guests facilities such as spas and gyms for their enjoyment. The lighting within these environments plays a critical role in the success of these spaces. When it comes to a gym, you want a well-lit space which enhances the physique of the guest and allows them to use weights and fitness machines safely. While on the other hand, spas and relaxation rooms require a luminaire which can create a relaxing environment.

FOS Lighting represents a range of products that are suited to use in recreational areas, while enhancing the overall experience of the guests.

VEKTA - V60140

V60140 is a special linear luminaire which offers a wide variety of optics for both direct & indirect illumination.

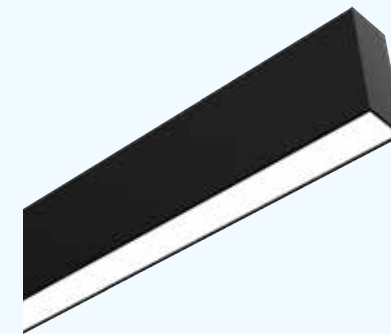

Features

- Direct & Indirect Illumination
- Custom Colours available
- Optics include: Louvers, Linear Lenses, Opal Diffusers, Track Mountings Include: Wire suspended, Rod suspended, surface mounted & Wall mounted.

FREND LIGHTING - CCD-E

CCDE is a downlight offering multiple beam angles and dimming options.

Features

- IP54
- Dimmable
- CCT options include: 3000K, 4000K, 5000K & 5700K
- Beam Angle 55, 100
- Dimming options include: Phase Dim, DALI & 1-10V



FORMALIGHTING - Fontanaluce

Recessed/ground mounted underwater luminaire with housing and tripod base.



Features

- IP68
- CRI>80
- Medium & Wide Beam angles available
- 3000K, 4000K, Tunable White & RGB/w version available

FREND LIGHTING - OMBRE GRID

OMBRE Grid is a low profiled troffer, with a unique diffuser allowing for a wide spread of light.

Features

- IP44 from below, IP30 from above.
- CRI>80
- High performance microprism center diffuser, secondary side diffusers & outer fine rib transition diffuser





Courtesy of: Formalighting

Multi Use Areas

Adaptable For All Scenarios

Hotels host a variety of functions, and to do it effectively, spaces need to adjust to the size and demand of the function, as well as different layouts for different activities, if the space can be manipulated on demand the lighting needs to as well. Motorised luminaires with a memory function become a valuable resource, allowing each luminaire to be adjusted to the customised floor plan. Motorised luminaires also reduce health and safety risks as there is no need for ladders, all luminaires can be adjusted from a simple interface on a phone or tablet.



FRENDRIGHTING - FWL-L

The FWL-L series is a variety of recessed & Surface mounted downlights, perfect for a variety of applications.

Features

- Optional IP65 lens (dependent on downlight)
- High Colour rendering downlight options
- Optional adaption plates for retrofitting (dependent on downlight)
- Optional IK10 accessories (dependent on downlight)

FORMALIGHTING -Moto-Zero

Moto-Zero is part of the Motolux range, which is a series of motorised remote controlled luminaires. Moto-Zero is perfect for direct table lighting as well as feature lighting.

Features

- CRI>90
- Size options include- 66mm, 100mm & 130mm.
- Available Colour Temperatures - 3000K, 4000K, Full Spectrum and Tuneable white.
- Optics include - Super Narrow (7°), Narrow, Medium & Wide.
- Vertical adjustment 90°
- Horizontal adjustment 350°
- Accessories include - Linear Spread, Honeycomb louver, Visor & Snoot.



FORMALIGHTING - Zero Due

Zero Due is a track mounted spotlight. The fitting is available in 4 sizes, as well as fixed or DALI options, and has a variety of accessories. Zero Due is perfect for direct table lighting as well as feature lighting.

Features

- CRI>90,95,98 options
- Available colour temperature - 2700K, 3000K, 4000K or Tuneable White and DimToWarm on request.
- Accessories include - Coloured Filters, Linear Spread, Honeycomb louver, visor and snoot.
- Optics Available - Narrow, Medium and Wide.



VEKTA - VEKTA Flex

VEKTA FLEX is a family of flexible LED Strips set in silicone. This makes them useful in exterior settings for atmospheric lighting or architectural feature lighting.

Features

- IP68.
- Vertical & horizontal flex direction.
- 11 available profiles.



FRENDRIGHTING FWL-L FORMALIGHTING Moto-Zero FORMALIGHTING Zero Due FORMALIGHTING Spotify VEKTA Vekta Flex VEKTA V60140 FRENDRIGHTING KATOE



Sourced from: Pexels.com
Photographer: Magda Ehlers

Technical Equipment Room

24/7 Activity

Technical equipment rooms require illumination that permits maintenance and repair. Maintenance may require higher levels of luminance than that provided by the standard lighting, this can be supplied by additional luminaires or portable luminaires. They also require standby lighting to ensure that any break in service continuity can be addressed safely and effectively. "Standby lighting is generally supplied by the energization of some, or all of the normal luminaires from an alternative power supply." AS/NZS 1680.2.4

In some of these spaces flammable/caustic gasses and liquids in the form of fuels and cleaning agents are stored, and illumination needs to be of a class that provides protection from the ingress of agents that can be a explosive hazard

FOS Lighting has a range of products which suit general illumination and additional illumination with high IP and IK ratings.



FRENDRIGHTING PBS FRENDRIGHTING SMS-LED FRENDRIGHTING VPBS ECOPOINT Large Downlight ECOPOINT Tri-Proof Plus SECURLITE Senspot SECURLITE Fila 2

FRENDRIGHTING - SMS-LED

SMS-LED is a surface mounted LED Troffer with a variety of optics configuration to best suit its environment.

Features

- Suitable for surface mounting or suspended (With Rod accessories).
- Heavy Duty Neoprene Gasket.
- White Acrylic or Microprism Diffuser options.



FRENDRIGHTING - VPBS

VPBS is a vandal-resistant, IP rated recessed troffer.

Features

- IP65.
- IK10.
- 6mm Polycarbonate lens.
- Heavy duty neoprene gasket.
- Future Proof replacement gear tray.
- White Acrylic or microprism diffuser options.
- 3000K or 4000K options available.
- 8 Wattage Configurations



ECOPOINT - Tri-Proof Plus

Ecopoint's Tri-Proof Plus is intended for use in environments where protection against a range of chemical agents or extra hygiene features are required.

Features

- IP67.
- IK09 (PMMA) or IK10 (PC).
- 316-grade stainless steel brackets.
- 4000K,3000K,5000K & 6500K Options available.
- 600mm, 900mm, 1200mm, 1500mm module lengths available.
- 20-48W Options available.
- Surface mounted or suspended.

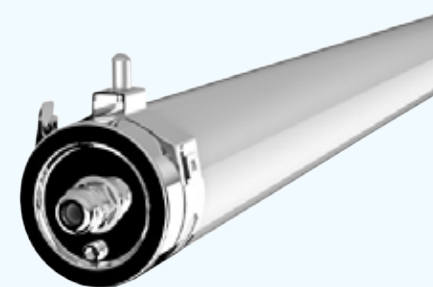

SECURLITE - Senspot

Extra-compact LED downlight with detection

Features

- IK10 or IK11.
- Clear/white polycarbonate diffuser.
- IP44 or IP65 options available.





Project: 31 Queen Street, Victoria

Ammenities

Hygiene Focused

Amenities require illumination that can withstand steam, moisture, and temperature variation. They also need to resist being wiped down or cleaned with chemical cleaning agents.

FOS Lighting both manufactures and imports a range of products from cost effective to exclusive designer fixtures that meet these requirements.



VEKTA - 60T

V60T is a circular linear fitting, which can be surface mounted or suspended, making it a great addition above wash stations.

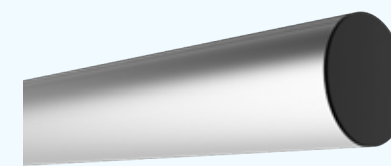

Features

- Available mounting options include Surface and suspend.
- Available IP65 LED Strip on request.
- Easy installation.
- Even light distribution.
- Custom colours available on request.

VEKTA - V1910IP

V1910IP is VEKTA Micros Waterproof linear fitting. With a small profile footprint and a variety of power outputs V1910IP is a great addition to amenities where atmospheric lighting, and under cabinet lighting is needed.

Features

- Even light distribution.
- Supplied with all mounting components.
- IP65
- Custom colours available.
- Easy installation.



FREN LIGHTING - KATO E

KATO E is a family of architectural lights which come in a range of mounting options, finishes, and outputs.



Features

- Modules include (Downlight, Pendant, Surface Mounted & Wall Mounted).
- 2700K, 3000K, 4500K, Dim to Warm & Tunable White options available across the entire range
- 250mm, 400mm & 600mm Can options available
- IP20 (Pendant)
- IP40 (Surface Mounted)
- IP44 (Wall Mounted)
- Black and white as standard (other colours available on request)

SECURLITE - Senspot

Extra-compact LED downlight with detection.

Features

- IK10 or IK11
- Clear/white polycarbonate diffuser
- IP44 or IP65 options available





Courtesy of: FREN D LIGHTING
Project: Collection House

Stairs & Lifts

Clean & Classy

Lifts provide a range of lighting opportunities, depending on the design of the space under consideration. Most lifts lead directly from the lobby/foyer of a hotel providing the opportunity to provide more than just functional illumination. The lift lobby becomes an opportunity to, via lighting, re-enforce the look and feel created by the main entrance lobby. It also requires the implementation of emergency lighting into the design as lifts and stairwells generally share space in the utility structure of modern buildings and provide egress in case of natural and man made disasters. Larger hotels also have cargo lifts for moving cleaning and exhibition material as well as food service to the various floors in the case of a multi-level structure. Stairwell lighting provide a different type of lighting requirement, the provision of luminaires with motion detection and emergency lighting in the case of power outages is central to the design requirements of stairwell illumination. FOS Lighting has a range of luminaires that meet the requirements of AS/NZS 2293.2:2019 both in terms of lumen output and backup battery life and employs designers that will ensure that the installation meets the requirements for safely ensuring the evacuation of structures.

FORMALIGHTING - Scala

Scala is an interior/exterior handrail recessed luminaire



Features

- IP67.
- Long life LED light source.
- Mono elastic clips.
- Stainless steel body.
- Light source provides IR & UV free emissions.

VEKTA - V1707

V1707 is a compact linear light, which is perfect for tight places such as pelmets.

Features

- Even light distribution.
- IP65 rated LED strip on request.
- Custom colours available on request.



SECURLITE - Voila Asymmetric

Asymmetric bulkhead fixture designed for stairways and communal areas. Great addition to Emergency stairways



Features

- IP55.
- IK10.
- Opal polycarbonate diffuser.
- Vandal resistant stainless screws.

SECURLITE - Fila 2

Fila 2 is an eye catching sealed, vandal-resistant striplight for illumination in areas where chemicals, moisture and vandalism may be present.

Features

- IP67.
- IK10.
- 66mm & 98mm diameter options.
- Louver options.
- 2mm thick polycarbonate.
- Custom signage available on request.
- Opal & Clear diffuser optics.





Courtesy of Megabay Project: Cloudland

Courtyards & Gardens

A Place To Relax

Modern Hotels and Spas have embraced the concept of indoor-outdoor flow and the importance of green spaces as part of the hospitality and wellness experience that they provide to their clients. These spaces need to be available and safe 24/7 which creates the need for illumination combined with sophisticated control systems that ensure that people can take advantage of the space 24/7. In addition to making the space available, hotels may wish to save on energy expenditure. To this end sophisticated control systems and motion detection systems can ensure that the users of the space always have illumination, while still meeting the requirement for energy effectiveness.

MEGABAY - Accento

Accento is a multipurpose exterior luminaire which accentuates features and highlights landscapes.



Features

- IP67
- Precision machined brass
- Narrow, medium, wide and flood optic options
- 5W, 8W & 12W options available
- Incorporating VDI technology which ensures that power is evenly distributed across the DC power network feeding the individual luminaires, preventing signal loss over long distances of cabling

FORMALIGHTING - Scala

Scala - recessed outdoor handrail luminaire

Features

- Mono elastic clip mount luminaire in a 316 grade stainless steel body
- Simple installation via snap-in catch
- Long life IR and UV free light source
- Optical polymer collimating lens
- IP 67



MEGABAY - Eclipse

Eclipse provides a unique form illumination for flora, with its unobtrusive design characteristics. It is also perfect for soft pathway illumination.



Features

- IP67
- Precision machined Brass
- Optional Hydrics™ finish
- Clear or diffused 5mm tempered glass
- 2700-5500K colour temperatures available
- Up to 80 lumens per watt
- Earth Spike or surface mounted options available

ECLATEC - Xeon

Xeon is a pole mounted luminaire which can be configured in a variety of styles.

Features

- IP66
- IK09 & IK10 (dependent on module)
- Any finish available
- Optional rendering, effects & patterns
- Optional integrated cameras and loudspeakers (dependent on module)



MEGABAY Accento MEGABAY Eclipse FORMALIGHTING Scala ECLATEC Xeon YOUNGKONG Woody ECOPOINT Compact Tri-Proof FRENZ LIGHTING Mr Bulkhead



Courtesy of: Formalighting
Project: Hyatt Regency

Paths & Walkways

Directing Access

FOS Lighting represents a number of ranges of products that are specifically designed for use in this environment, right up to luminaires that are designed to be fully submerged in water. In this regard Megabay (TM) is a speciality producer of luminaires for landscaping and the illumination of building facades. FOS Lighting also provides several ranges of bollards and similar multi purpose luminaires that provide wayfinding and security on paths and walkways.

FREND LIGHTING - Mr Bulkhead

Exterior bulkhead fitting, suitable for wall or surface mounting. Available in two sizes with maintained emergency in the larger format.



Features

- Die-cast aluminium body.
- Polycarbonate diffuser.
- Silicone Gasket.
- Integral Control Gear.
- Black powder coated (As standard), other colours available on request.
- 3000 or 4000K options available
- Security Grill and Eyelid accessories available.

MEGABAY - Eclipse

The Eclipse provides a unique form of down lighting for ground flora when vantage points prove challenging. It's the unobtrusive solution for gently illuminating pathways with soft, uniform and discreet illumination.

Features

- IP67.
- Brass or Hydrics plated finishes.
- Clear or Diffused Glass.
- 2700K to 5500K options available.



ECLATEC - Keo

KEO is a decorative urban pole mounted luminaire, designed for high traffic public spaces.



Features

- IP66
- IK10
- Any colour finish available
- Extruded silicone gaskets

ECOPOINT - Step/Night Light

The step/night light is a low-profile, discreet, and robust fitting, creating a safe level of lighting for orientation.

Features

- IP54
- Cast aluminium body
- Low powered LED
- Range of sizes
- Minimal cavity space

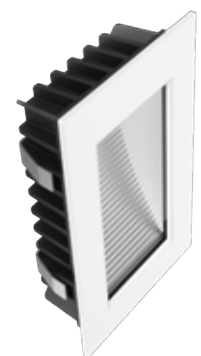

FRENDRIGHTING
MR Bulkhead



YOUNGKONG
Eclipse



MEGABAY
Eclipse



SEICURLITE
Fila 2



ECOPOINT
Step/Night Light



ECLATEC
Teo (Bollard)



ECLATEC
Keo



Courtesy of: Megabay
Project: Cloudland

Facade Lighting

Hotel Business Card

Lighting building facades - whether it be to purely illuminate architectural details or produce multi coloured displays that promote your brand or make your structure stand out, FOS Lighting has the means to fulfill your vision. Facade lighting ideally has to combine sufficient lumens to illustrate architectural details with a lighting design that minimises wastage that impacts on Dark Sky outcomes. This calls for exceptional optics and weather resistance in the design of the installation. FOS Lighting represents several brands that provide a range of facade lighting solutions, from basic to colour changing computer-controlled projectors capable of adaptive lighting displays.



MEGABAY Viento MEGABAY Omnyx VEKTA Flex FRENK LIGHTING EWW YOUNGKONG Leo YOUNGKONG Thor YOUNGKONG Prime

MEGABAY - Viento

Viento is a powerful linear system providing uniform illumination for both indoor and outdoor applications



Features

- Waterproof connectors.
- Simple set up.
- IP66
- Tempered glass lens.

MEGABAY - Omnyx

The Omnyx range of sub-miniature luminaires offer decorative yet functional lighting design. Its robust brass construction and waterproof rating allows the Omnyx to withstand the harshest of environments to produce stunning effects.



Features

- Easy Installation.
- IP68.
- 5mm flat tempered glass or 11mm domed tempered glass diffuser.
- Optional install tube.

VEKTA - VEKTA Flex

VEKTA FLEX is a family of flexible LED Strips set in silicone. This makes them useful in exterior settings for atmospheric lighting or architectural feature lighting.



Features

- IP68.
- Vertical & horizontal flex direction.
- 11 available profiles.

YOUNGKONG - Thor

Thor is a flood luminaire designed for use in exterior gardens and building facades.

Features

- Advanced heat control.
- Clear tempered glass.
- 120° tiltable hinge, 170° rotatable plate.
- IP66.





Courtesy of: Ecopoint
Project: Century City Parking

Parking

Safe and Bright

Parking complexes can be an unnerving and difficult environment to navigate, and even worse when at night. A well-designed lighting solution should offer ample light both day and night as well as maximise visibility when moving to and from a vehicle. FOS Lighting offer a range of exterior and undercover parking solutions, which are waterproof, reliable, and efficient. When combined with a suitable control system, these luminaires, via daylight harvesting and motion detection via on-board sensors can save a significant amount of expenditure on energy, helping to control the carbon footprint of the Hotel.



FREND LIGHTING CWP FREND LIGHTING Prism FREND LIGHTING SMHF-LED FREND LIGHTING SPF-LED ECLATEC Stelium ECLATEC Zelda SECURLITE Fila 2

ECOPOINT - Compact Tri-Proof

A rugged polycarbonate construction with IP65 and IK08 protection ratings has been paired with a modular design, DIP switch power adjustment, as well as tool-free installation, improving usability and reliability.

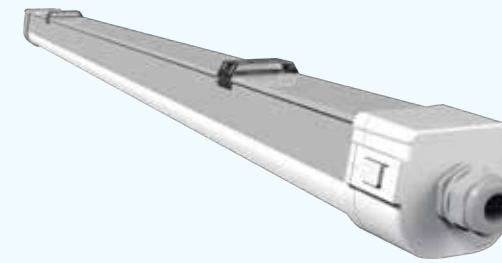

Features

- Available as small and large in 1200 and 1500mm variants
- Available in High CRI SOLUS option.
- Cable entry; end entry, through wireable.
- Optional Microwave sensor on-board
- Replaceable/upgradeable light engines and drivers simplify maintenance and extend product service-life.

FREND LIGHTING - ETW

ETW is a weatherproof luminaire, with a variety of options to suit your lighting needs.

Features

- IP65.
- L70 B50.
- Rated for 50,000 hours.
- IK08.
- High Impact polycarbonate body.
- High impact diffuser.



ECOPOINT - Area Light G2

Lighting large areas economically is comfortably within reach when using Ecopoint's Area Light G2.

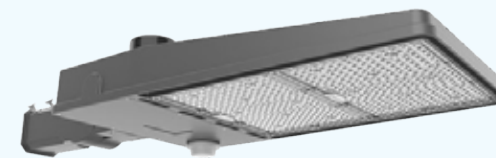

Features

- IK08 (Pending).
- IP66.
- 7 Wattage options.
- Up to 419000 lumens.
- Pole or surface Mounted.
- CCT options include 3000K, 4000K, 5000K, 6000K.

SECURLITE - Fila 2

Fila 2 is an eye catching sealed, vandal-resistant striplight for illumination in areas where chemicals, moisture and vandalism may be present. With custom signage available directing guests could never be easier

Features

- IP67.
- IK10.
- 66mm & 98mm diameter options.
- Louver options.
- 2mm thick polycarbonate.
- Custom signage available on request.
- Opal & Clear diffuser optics.



FOS Projects

Australia

- 12 Micron
- 151 Castlereagh St Sydney Café/ Lift Lobby
- Alba Thermal Spring
- Bondi Pavilion
- Burwood RSL - NSW
- Cabra Vale Diggers
- Campsie RSL
- Camsie RSL - NSW
- Castle Hill RSL - NSW
- CityFitness Whangarei NZ
- Coogee RSL - NSW
- EOT & Wine Bar 99 Macquarie St Sydney
- Good Heavens Rooftop Bar - Melbourne
- Hayman Island
- Hoyts Broadway - NSW
- Hoyts Chadstone - VIC
- Hoyts Chatswood - NSW
- Hoyts Cronulla - NSW
- Hoyts Entertainment Quarter
- Hoyts Frankston - VIC
- Hoyts Highpoint - VIC
- Hoyts Melbourne Central
- Hoyts Norwood - SA
- Hoyts The Base - Hamilton NZ
- Hurricanes Narellan
- Kingston Hotel - Richmond
- Kyomi Restaurant
- Oaks Sydney Hyde Park
- Railway Hotel Brunswick
- Royal Oak Hotel Lidcombe - NSW
- Sake
- Sean's Kitchen
- Seven Hills Toongabbie RSL
- Shed Café - Ed Square
- SS&A - Albury - NSW
- Star City
- Victor Church Meats - Prahran
- Woomera Eldo Accommodation - SA





FÖS
lighting

info@foslighting.com.au

foslighting.com.au

1300 241 087

FOS Lighting reserves the right to make any changes without prior notification