

MR

EXTERIOR BULKHEAD WALL MOUNTED / SURFACE MOUNTED

FEATURES

- Vandal Proof Exterior Bulkhead.
- IP65 Rated.
- L75 B50@50,000.
- Die-cast Aluminium Body.
- Polycarbonate Diffuser.
- Silicone Gaskets.
- Integral control gear.
- Available with a security grill for extra protection.
- Eyelid option available (MR17 only).
- Black powder coat finish, other colours available on request.
- PLC available on request.



Specifications	
Diameter	260mm - MR13
	360mm - MR17
Depth (Standard)	125mm - MR13
	150mm - MR17

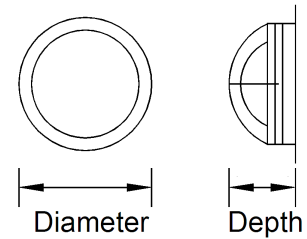

Technical Information		
Series	System Power	Board Output
MR13	15.3W	1500 (lm)
MR17	22.2W	2500 (lm)

PRODUCT CODE

Example code: **MR17/GR/LED/40**

Specifications subject to change without notice.

Product Series	Size	Option	Type	Colour Temperature	Emergency Option
MR	13 Small	(Blank) No cover	LED	30 3000K	ME Maintained Emergency (MR17 only)
	17 Large	GR Grill		40 4000K	
	EL Eyelid (MR17 only)				

FREND
lighting

phone 1300 241 087

fax (617) 3272 9000

email sales@foslighting.com.au

PO Box 268

14 Jaybel Street, Salisbury

Brisbane QLD 4107

www.frend.com.au